

FINLANDIA
TALO HALL

ELEMENTS OF
EXPERIENCE



EXPERIENCES AT AN EXCEPTIONAL LOCATION

Excellent connections around the world. Helsinki Airport is one of the best airports in Europe



New York 8h 40min
San Francisco 11h
Dallas 10h 40min
Seattle 9h 45min

London 3h 15min
Amsterdam 2h 30min
Paris 3h
Rome 3h 25min

Shanghai 13h
Singapore 11h 30min
Delhi 6h 40min
Dubai 6h 10min

107

destinations in 2024

28

airlines

15.3 M

passengers in 2023

*Direct flights
winter 2024-2025*

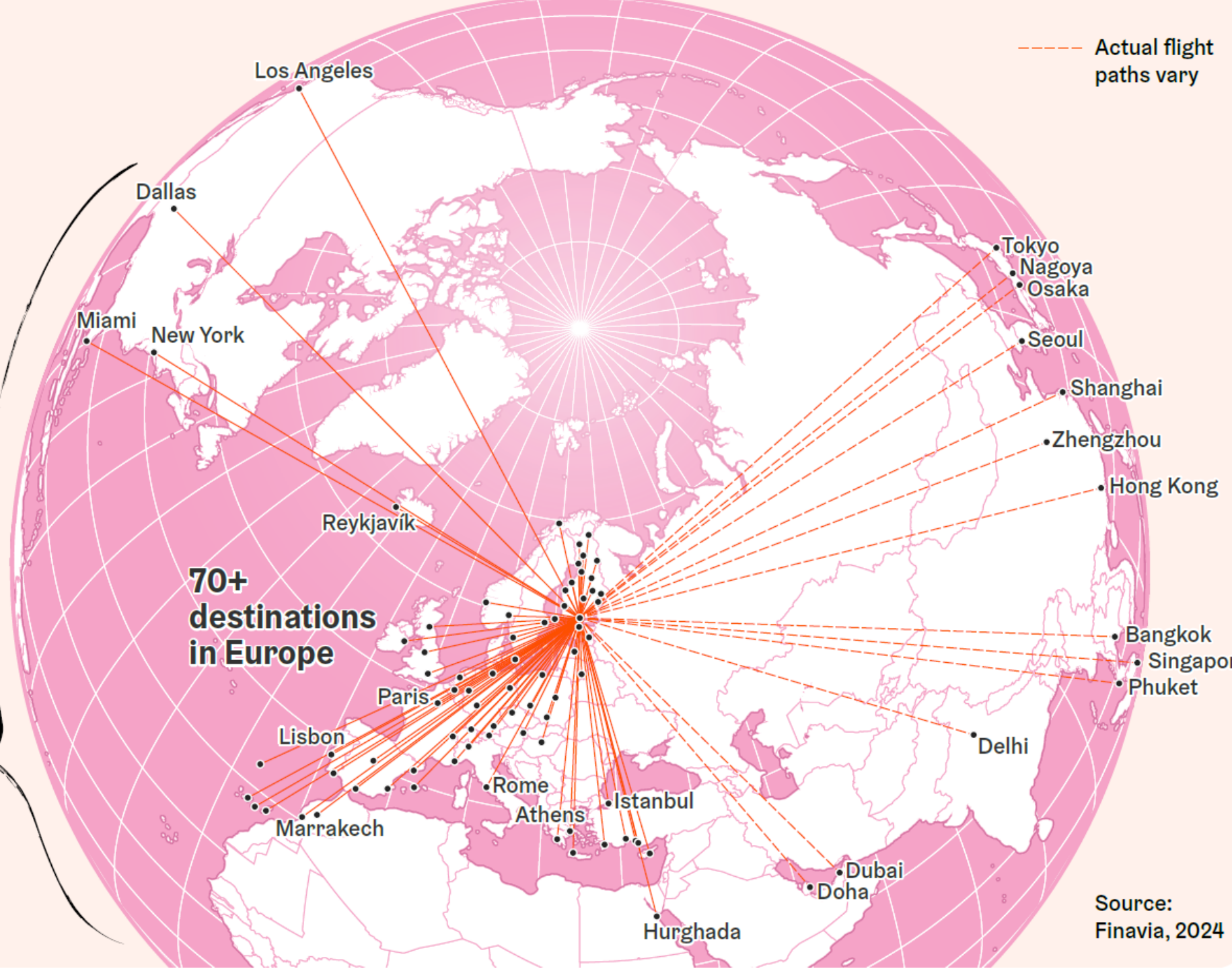

Source:
Finavia, 2024

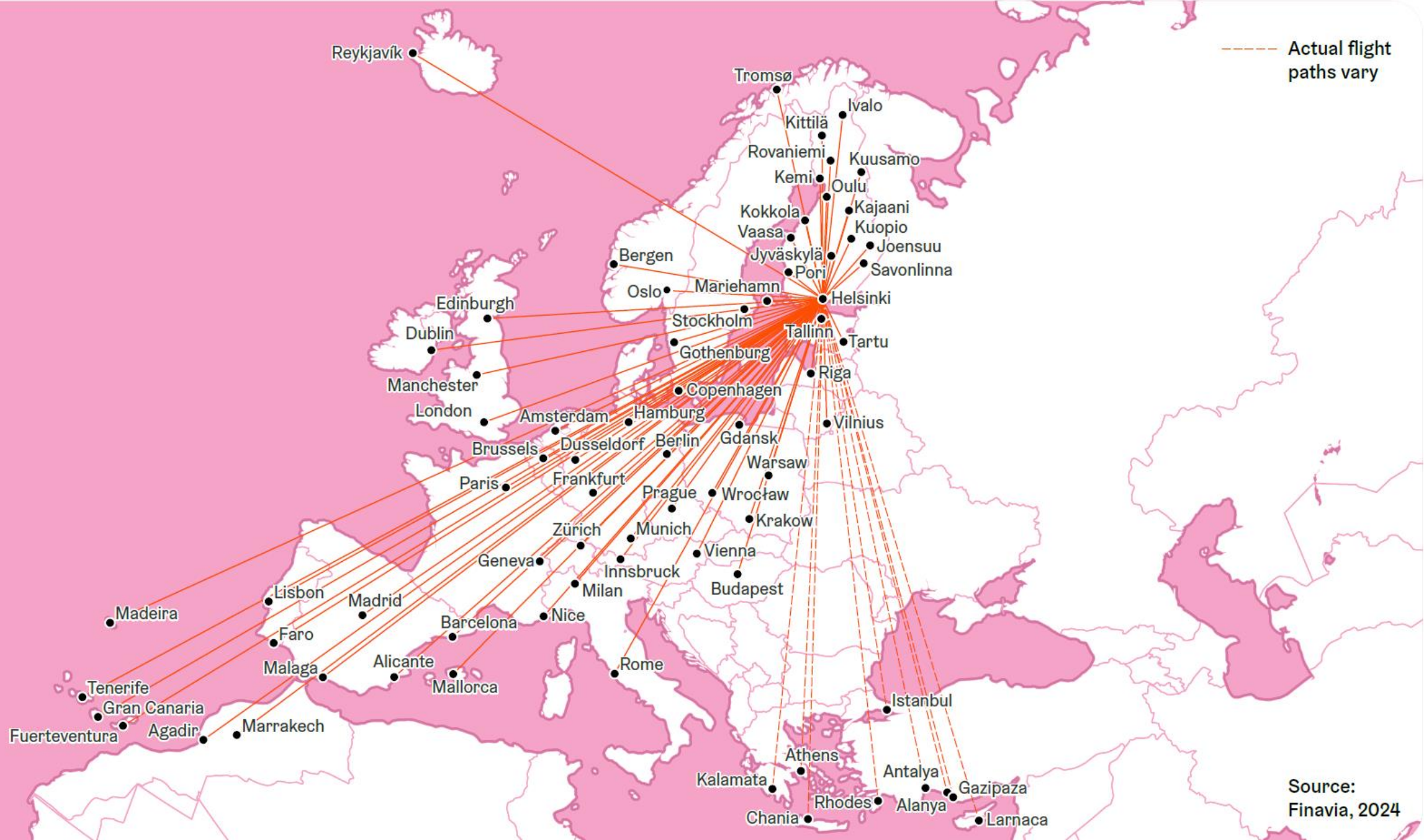

Source:
Finnair, 2024

Accommodation

Hotel rooms

15,400

rooms in Helsinki



22,000

total hotel rooms
in the Helsinki
Metropolitan Area

Source:
Helsinki Partners, Visit
Finland, Airbtics 2024

Airbnb listings

● ● ● **2,861**

active listings as of 9/2024

Helsinki hotel rooms by rating

5-star

● **1,400** rooms

4-star

9,650 rooms



3-star

● **1,450** rooms

2-star

● **800** rooms

Apartments and hostels

● ● **2,100** rooms

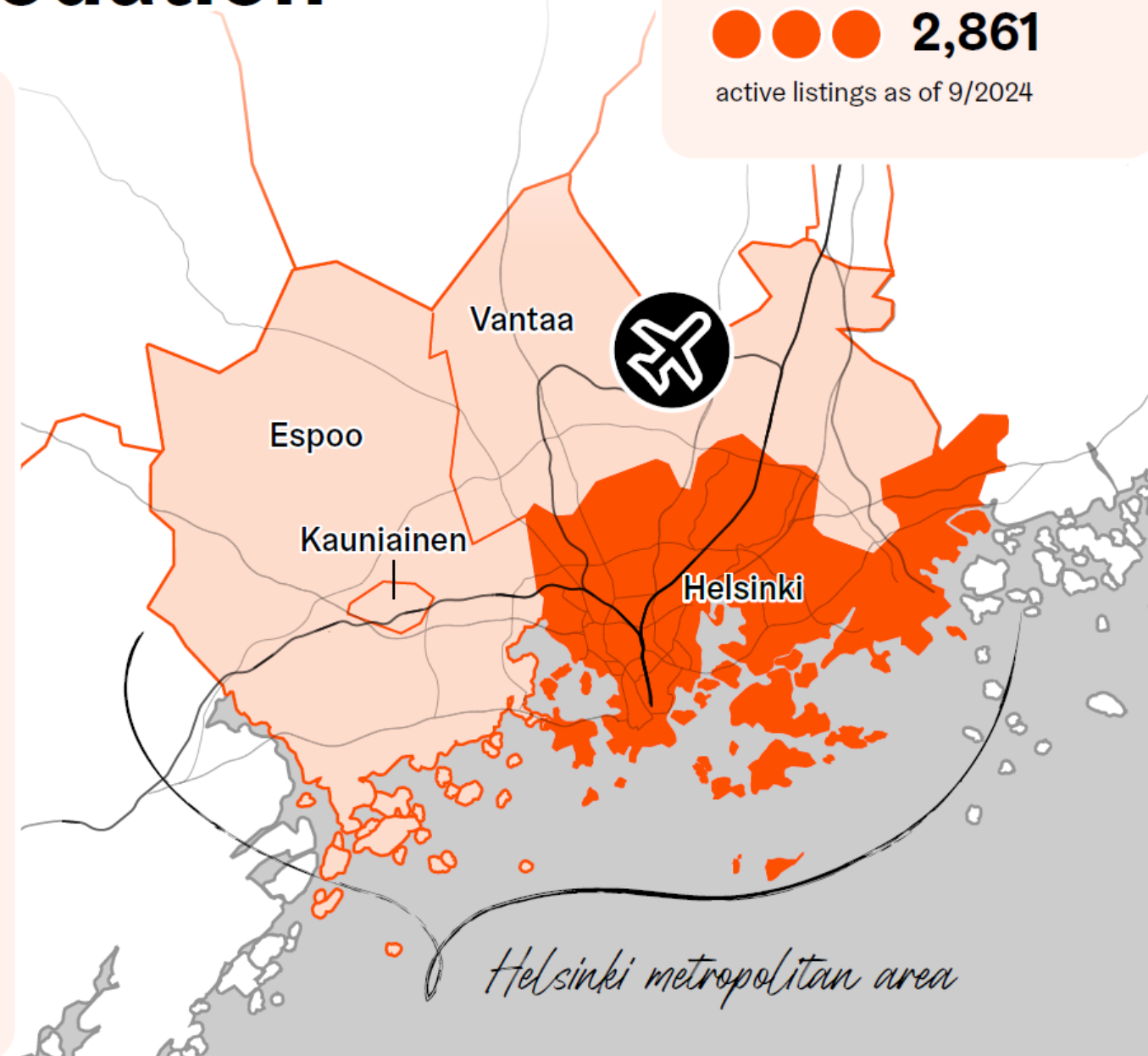

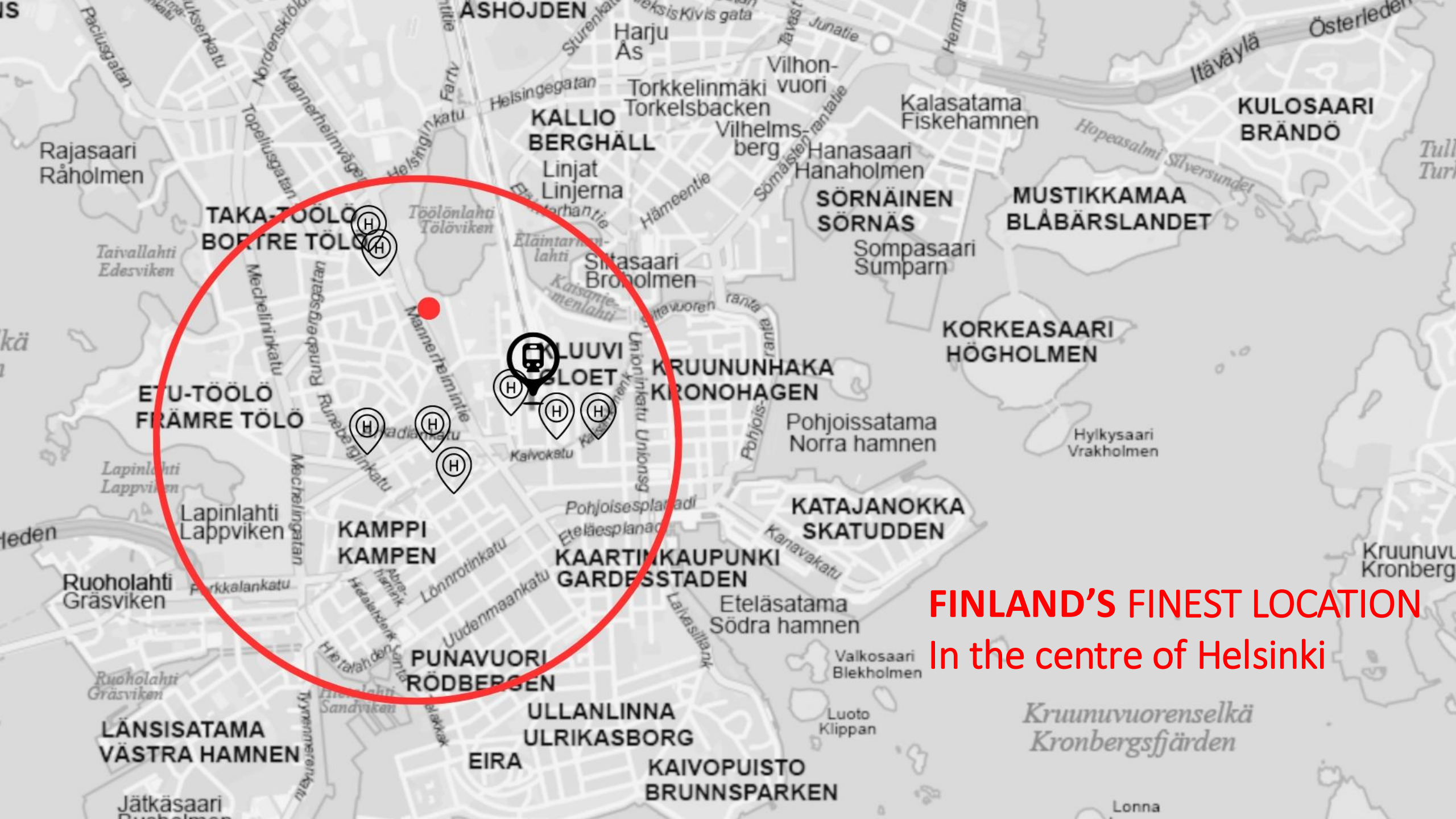

FINLAND'S FINEST LOCATION
In the centre of Helsinki





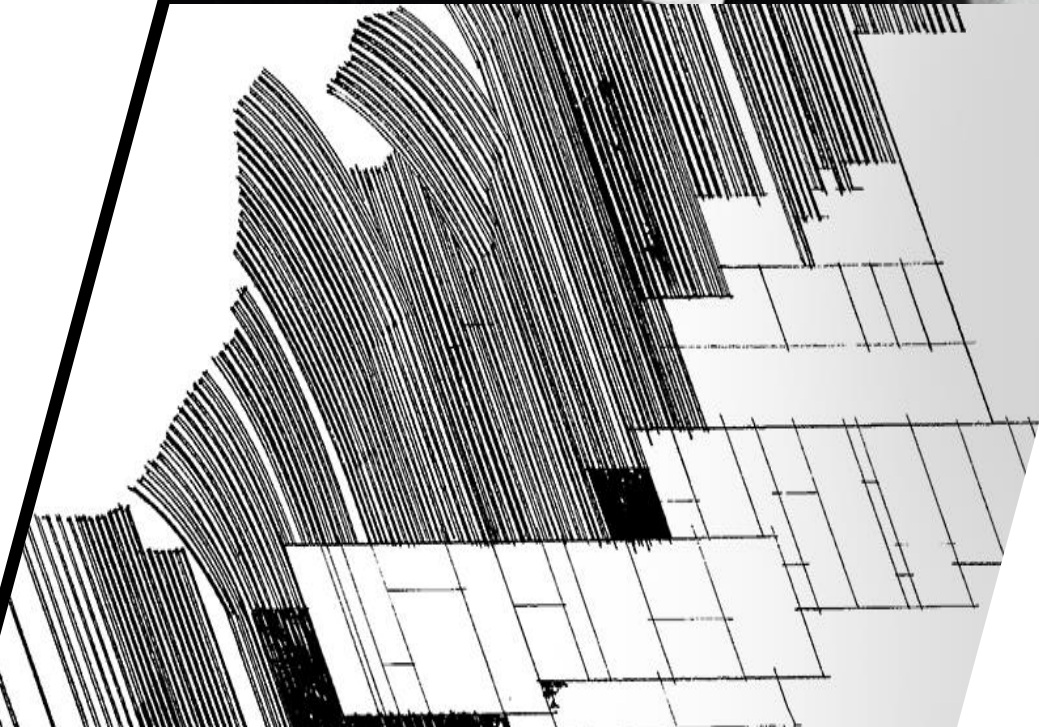
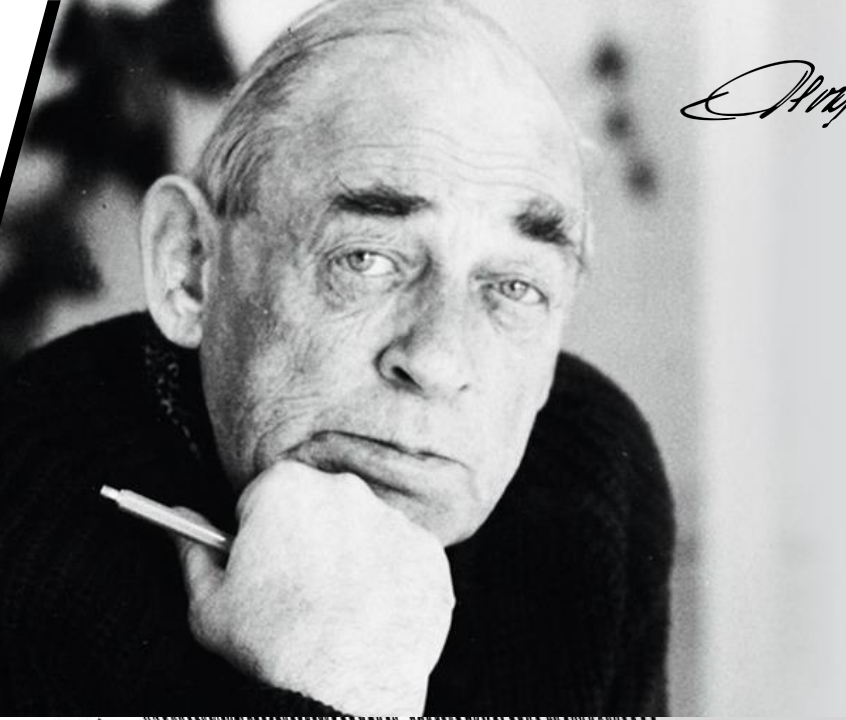

ELEMENTS OF WOW

THE WORK OF A MASTER

- Finlandia Hall is designed by the world-famous Finnish architect Alvar Aalto (1898-1976)
- Finlandia Hall is an unequalled international classic of architecture and design – down to the finest detail.
- Decades of Experiences starting from 1971



A BEACON OF DESIGN

CLASSICS INSIDE A CLASSIC

- Finlandia Hall combines design, functionality and atmosphere in a unique way.
- Full of design details and unique Aalto furniture.
- Finlandia Hall is an unequalled international classic of architecture and design.



CORNERSTONES OF OUR RESPONSIBILITIES

OUR BUSINESS IS
CERTIFIED BY ISO
STANDARDS

WE FOLLOW
COMMITMENT2050.FI
PRINCIPLES

OUR ENERGY
PERFORMANCE IS
CONTROLLED

WE HAVE EMISSION
REDUCTION PLAN

WE RECYCLE AND
REDUCE WASTE

WE ARE CLIMATE
PARTNERS OF CITY
OF HELSINKI

WE ARE ON STEP 5
OF THE ORGANIC
FOOD PROGRAM

WE ARE
#THINKSUSTAINABLY
VENUE IN HELSINKI

OUR EMPLOYEE
WELLBEING IS HIGH

WE WILL BE CARBON
NEUTRAL BY 2035

WE REQUIRE
RESPONSIBILITY ON
ENTIRE SERVICE
CHAIN

OUR CORPORATE
GOVERNANCE IS
STANDARDIZED





A SYMPHONY OF TASTES

OUR FOOD FILOSOFY

- Ingredients from Finnish nature and Finnish producers
- Using local specialities from all parts of the country.
- Signature dish: Taste of Finlandia plate
- Mainly vegetarian proteins, fish and game, less red meat
- Less waste, more taste



EXPERIENCE
FINLANDIA



SEE – EXPERIENCE
- FEEL





NEW

ELEVATE YOUR SENSES

EXPERIENCE FINLANDIA EXPERIMENTAL EXHIBITION

- The exhibition script tells a story of Finland, design, Finlandia Hall, creativity, and the future through the lens of Aalto's architecture. It celebrates the people who created Finlandia Hall and those who bring this iconic event venue to life.
- Themes: Architecture, Design, Forest, Finland
- Total area ca 1300 m², max 300 pax
- Multiple opportunities for the event organisers: private cocktail receptions, dinners, workshops, guided tours



Parantalan muitten huoneitten rakenteesta on mainittava: suuremmat salit kuten ruokasali ja työsalit ovat siivessä B, suunnattuina suoraan etelään.

Alvar Aalto 1933

On the structure of the other rooms in the sanatorium: larger halls such as the dining room and the work room, located in the B wing, face directly south.

Alvar Aalto 1933

PARANTAVA VALO HEALING LIGHT

Päivän suunnittelun lähtökohdat olivat auringonvalon maksimointi ja parantamisen, jota sanatorio edisti hoitojen ja parantolaitoksen rakentamisen avulla. Parantolaitoksen lämpöä säätöhuone, vesi- ja sähkökeskukset, lääkintä- ja sairaalakeskus sijaitsivat luonnon valon lämpöä hyödyntäen. Keskeisessä osassa luonnon valon lämpöä hyödyntäen suunniteltiin lämpöä säätöhuone, vesi- ja sähkökeskukset. Keskeisessä osassa luonnon valon lämpöä hyödyntäen suunniteltiin lämpöä säätöhuone, vesi- ja sähkökeskukset. Keskeisessä osassa luonnon valon lämpöä hyödyntäen suunniteltiin lämpöä säätöhuone, vesi- ja sähkökeskukset.

The design of Parantala Sanatorium was based on maximizing sunlight and heating on the patient sanatorium, which was called both Parantala and with the help of a parantala of a patient room. The placement of windows, lighting, water scheme and thermal design of the room took into account the needs and properties of a sanatorium ward. For example, the north-facing in the rooms were designed to receive maximum solar radiation. The Finnish made for the sanatorium, the need for a space for patients to breathe with sitting. It was also important to make the furniture and furniture easy to clean. Even the door handles of the patient rooms were designed so that they would not catch the dust of a passing doctor or nurse.

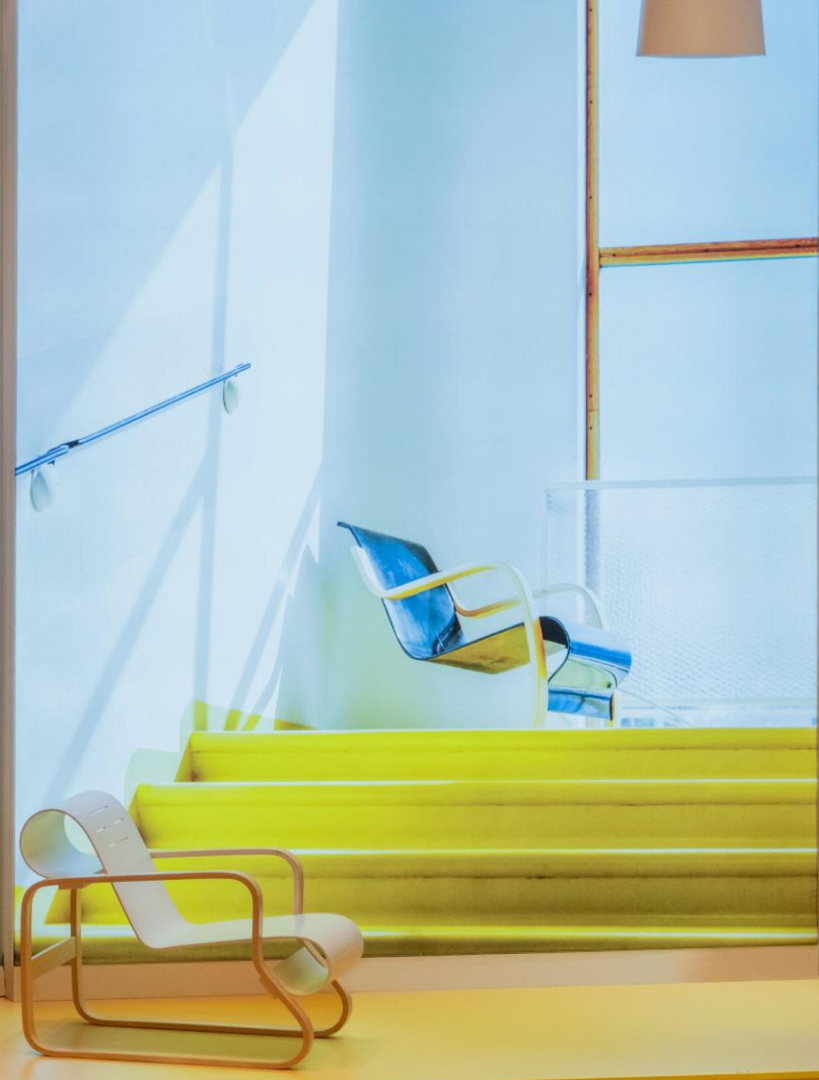



ALVARO ALTO
ALVARO'S FOREST

Alto's forest is a masterpiece of modernist architecture, designed in 1951. It is a prime example of his 'organic architecture' style, which seeks to harmonize buildings with their natural surroundings. The forest is a prime example of his 'organic architecture' style, which seeks to harmonize buildings with their natural surroundings.



Kaikkessa on luonnon
Aalto on luonnon
on pohjimmaisena
tuntuma metsän
maailmaan,
metsänviisius...

Göran Schildt 1982

There is
an underlying
sense of the forest
world in all of Aalto's
work, the wisdom
of the forest...

Göran Schildt 1982







EXPLORE THE SPACE

LEGENDARY FINNISH DESIGN FACILITIES

- Our facilities are flexibly customizable for events of all kinds and specific individual needs.
- 44 spaces
- 10-6 500
- Main Auditorium 1 672

3RD FLOOR

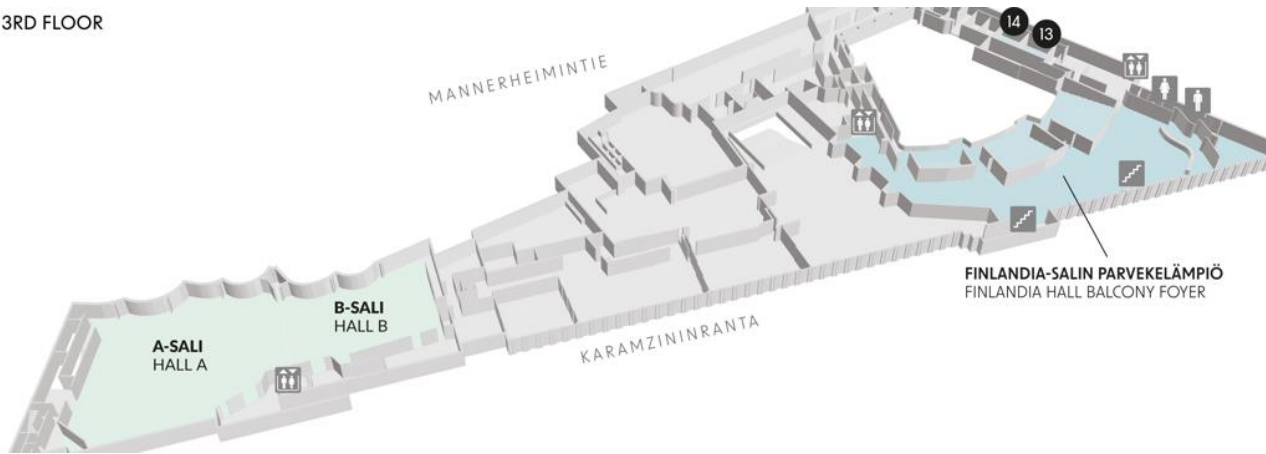

I. KERROS
1ST FLOOR



2nd Floor

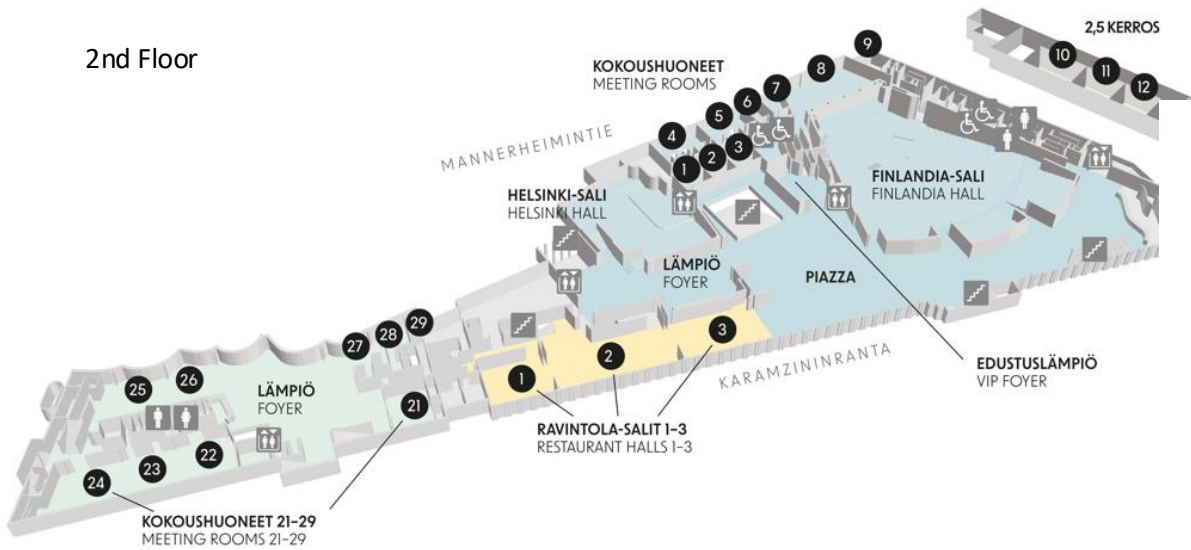

Floor 0

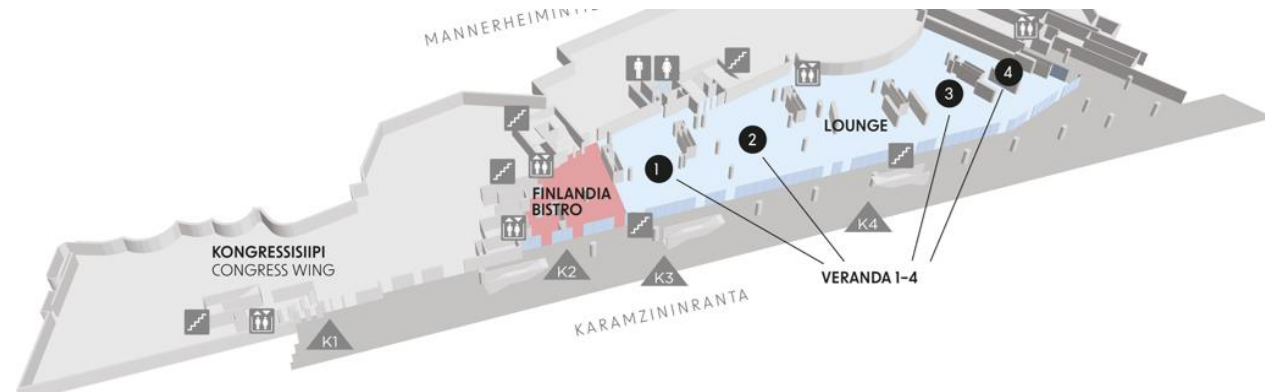

FINLANDIA HALL FLOOR PLANS

Finlandia Hall Auditorium

Total occupancy	1 672
Stalls	1 162
Balcony	510





#IBMCI97



IBM BusinessConnect
Tartu hetkeen!









Office 365

Windows

Windows





NLANDIA
SERTINGI
SERTIALEN
KERTI HELL



EXAMPLE OF CONFERENCE USE OF SPACE

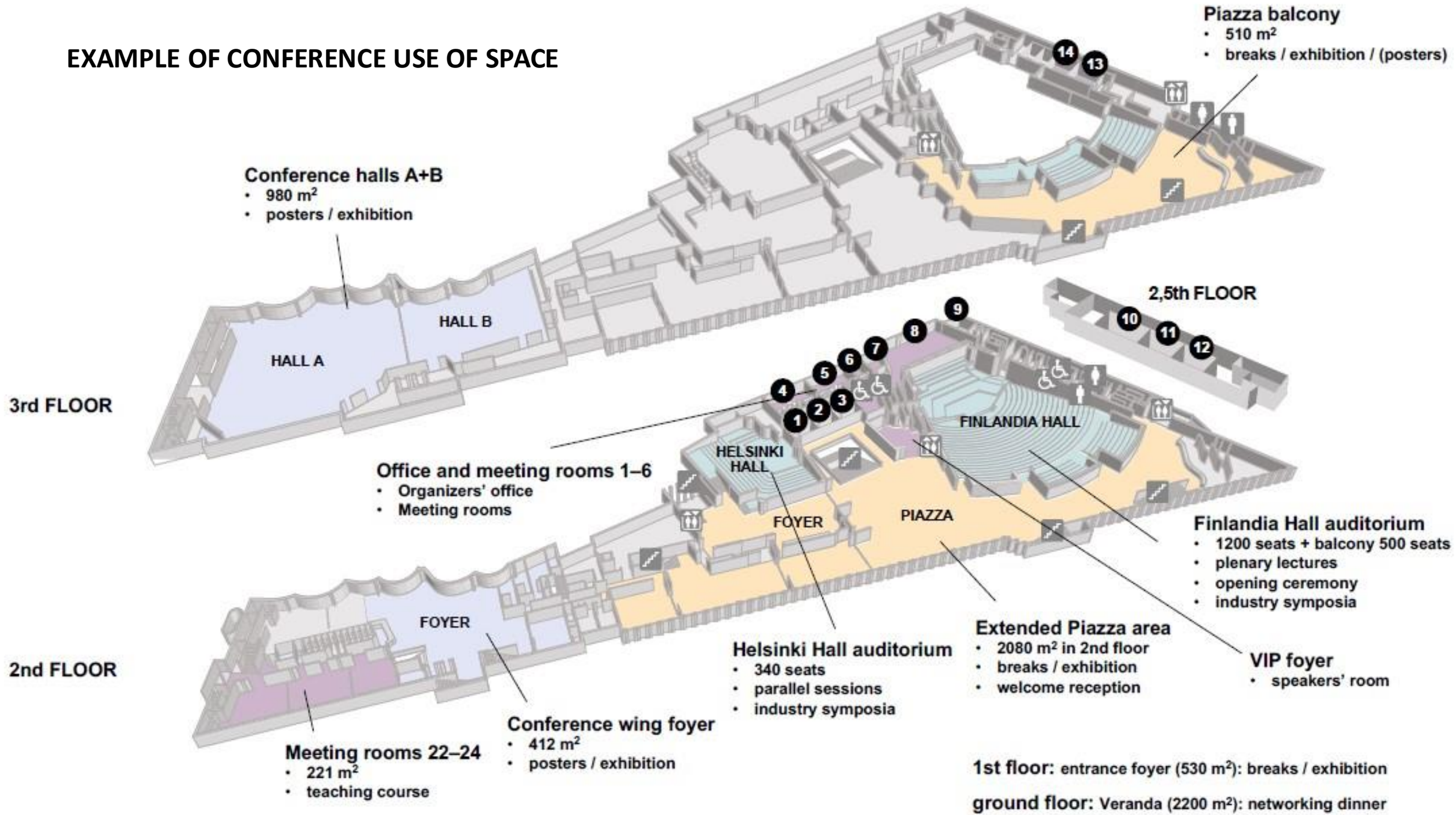

Exhibition:

Piazza: 1340m²

Restaurant Halls: 430m²

Helsinki Foyer: 310m²

Total 2080m²



PROVISIONAL FLOORPLAN (FOR REFERENCE ONLY)
EXHIBITION AND BUFFET CATERING

Main Building

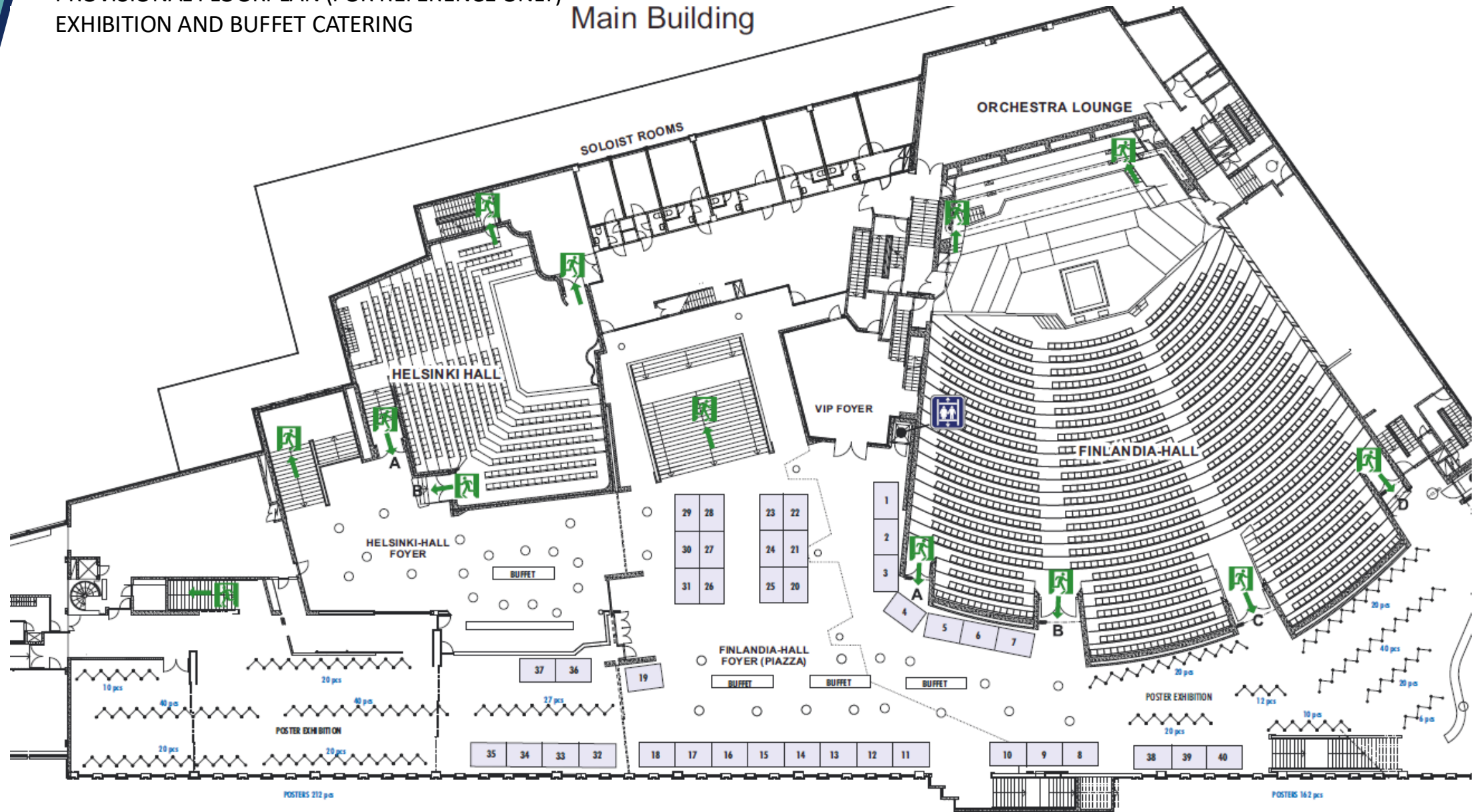

Congress2025

1800pax

Exhb 482m2 net

Main Building

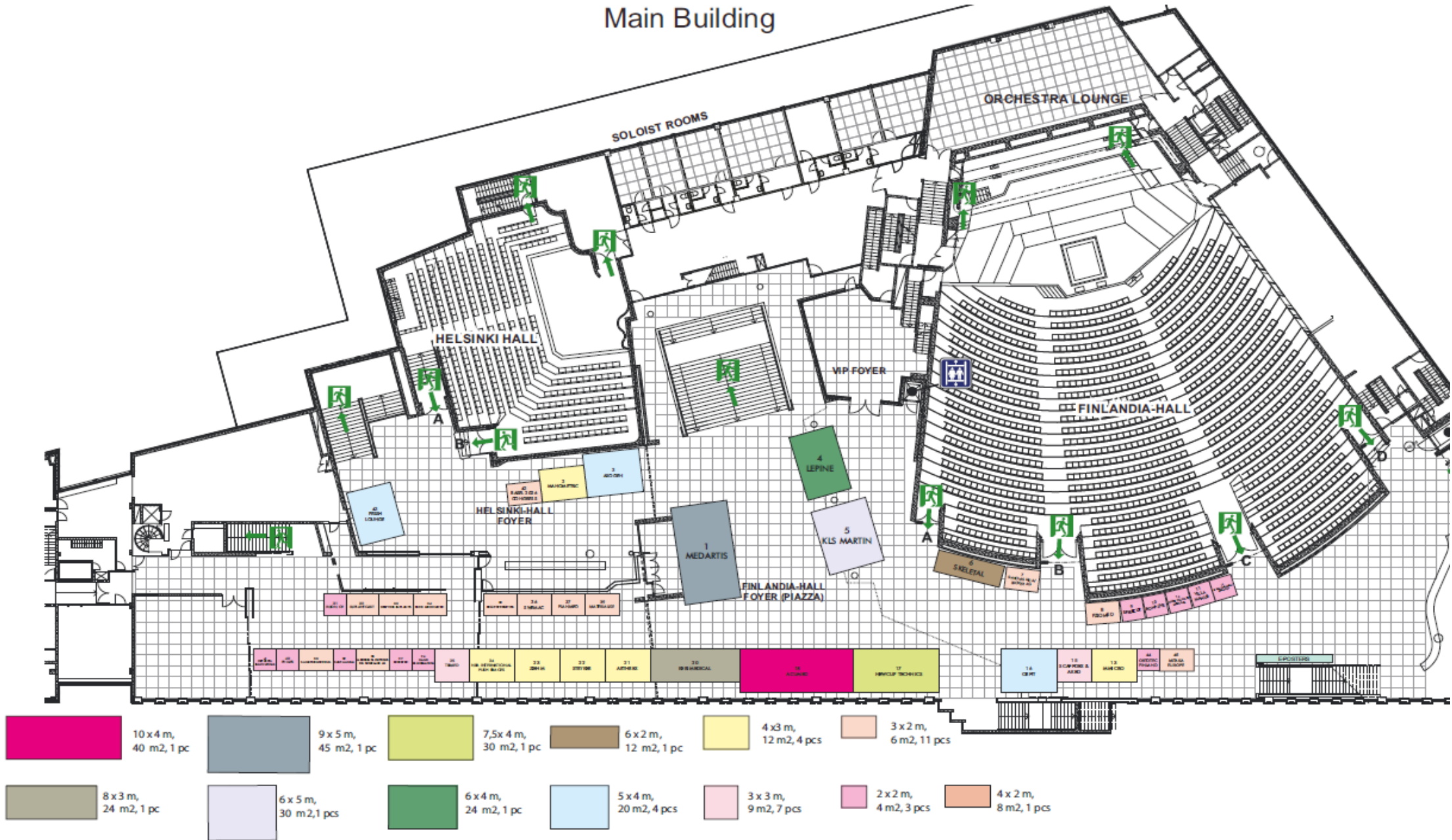



The Acumed Advantage

acumed

acumed

A Complete Range of Innovative Hand & Wrist Solutions

IMPROVE YOUR STRENGTH AND RANGE

acumed



YOUR BUSINESS MATTERS



LÄHITAPIOLA

Autolesi sopivimmat
vakuutukset ja rahoitukset
LähiTapiolasta

Suomen suosituin
autovakuutus
LähiTapiola

EXAMPLE OF SERVICE

Welcome Reception/Evening Event

2200 pax

Piazza & Restaurant Halls &
Helsinki Hall Foyer

2080m²







Gala Dinner - 1200 pax
Piazza & Restaurant Halls & Helsinki Hall Foyer, 2080m²







StaffPoint

Käytännöllistä työtä paremman työelämän puolesta!



Käynnyn parantaminen - tulosten lisääminen 2020.



EY Entrepreneur of the Year



EXAMPLES OF FACILITIES

VIP Foyer (private entrance to Finlandia Auditorium)



Helsinki Hall & Foyer

Helsinki Hall 340 pax
Helsinki Hall Foyer 310m²



HELSINKI
KAMARISUUNNITUS
KANSAINVAIKKAVAN
CHAMBER MUSIC HALL





#PurdueByChoice

Beate 00 @beate00
We are moving to the point of the discussion on Purdue being free participants in its own right #PurdueByChoice

Beate 00 @beate00
It is @PurdueByChoice. Did you prepare yourself for the possibility that you would not return from the mission. #PurdueByChoice

Paul 00 @paul00
This is a great idea! Paul Adams thought before the Apollo flight, watching actual news in China Beach #PurdueByChoice

Paul 00 @paul00
Paul Adams thought before the Apollo flight, watching actual news in China Beach #PurdueByChoice



#PurdueByChoice

View #PurdueByChoice





Microsoft

GRW

EXAMPLES OF FACILITIES

Restaurant Halls

Exhibition: 430m²
Meeting: Hall 1 - 90 pax,
Hall 2 - 200 pax,
Hall 3 - 160 pax
Dinner: 270 (rounds),
340 (square)





INVESTOR DAY **EMTECH** RAISING MONEY FROM US-BASED LPS



IAIN MARTIN
Forbes



CHRISTIAN MEERMANN
Cherry Ventures



KATHERINE WYBLE
WISIMCO



JULIE ZHANG
WashU IMC

MAIN PARTNERS

OpenAI

SUPPORTING PARTNERS

Helsinki Partners

even

id





Meeting rooms

IN COMBINATION WITH HELSINKI HALL
OR FINLANDIA HALL AUDITORIUM









EXAMPLES OF FACILITIES

Veranda 2

Meeting:	400 pax
Exhibition:	414m ²
Seated Dinner	210 pax



VERANDA HALLS

Veranda Halls (theatre): 195-400 pax / hall

Veranda 1	233m ²
Veranda 2	414m ²
Veranda 3	236m ²
Veranda 4	272m ²
Veranda 1-4	1 150m ²

Veranda halls incl foyer areas: Total 2200m²





AIKAHAUSMEDIA









CONGRESS WING

Hall A (theatre) 600 pax, 635m²
Hall A (rounds) 290 pax

Hall B (theatre) 250 pax, 345m²
Hall B (rounds) 130 pax

Hall A+B (theatre) 900 pax,
980m²
Hall A+B (rounds) 430 pax







EXAMPLE OF SERVICE

Seated Dinner

Congress Wing Hall A&B
Seated dinner
570m², 440 rounds





EXAMPLES OF FACILITIES

Meeting rooms 21-24

170 pax theatre style



EXAMPLES OF FACILITIES

Meeting rooms 21-24

35-60 pax

52m²-83m²

one room or combinations







FINLANDIA
CAFE & WINE





FINLANDIA
DESIGN SHOP



FINLANDIA
BISTRO





FINLANDIA
HOMES





1. KERROS

1ST FLOOR

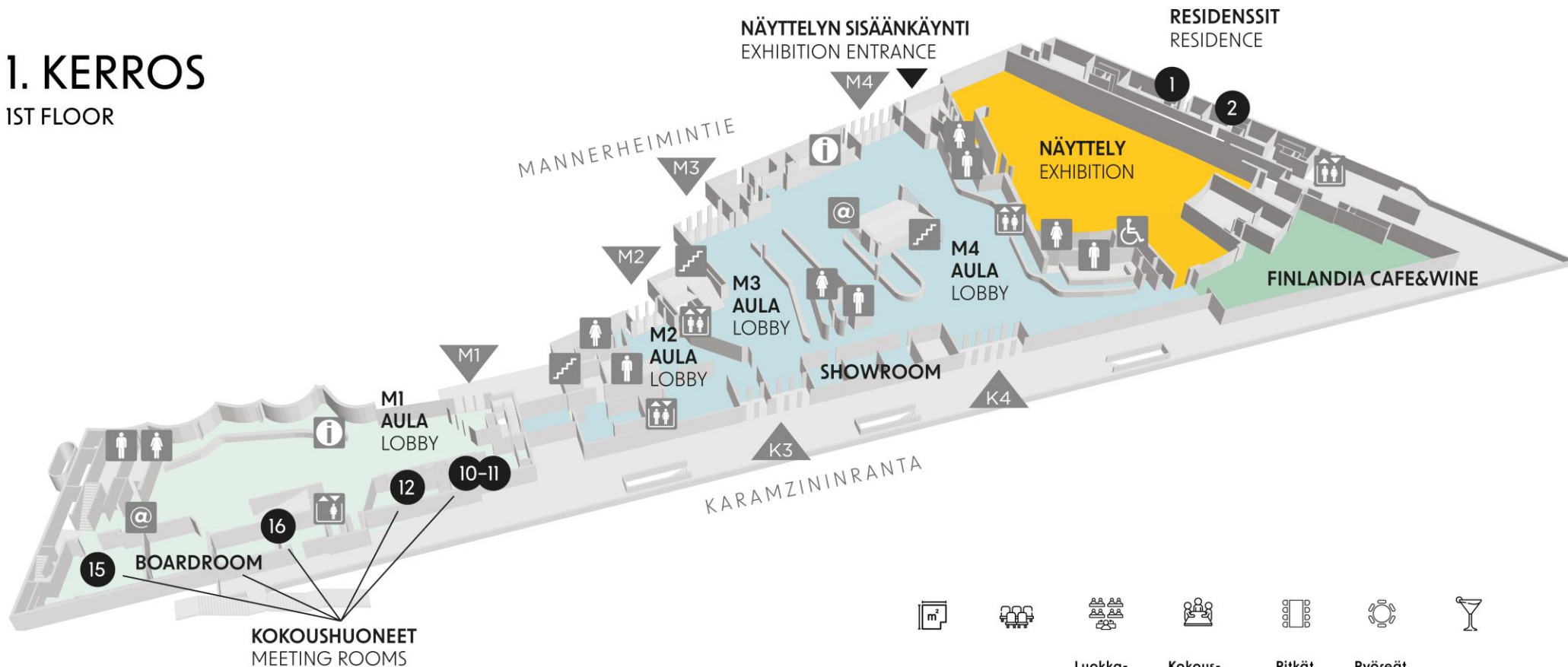

1. KERROS · 1ST FLOOR

	m ²	Tuolirivit Seating	Luokkamuoto Classroom space	Kokouspöytä Meeting table	Pitkät pöydät Dinner tables	Pyöreät pöydät Round tables	Cocktail Cocktails
NÄYTTELY · EXHIBITION							
FINLANDIA CAFE&WINE	224						
RESIDENSSI 1 · RESIDENCE 1	57						
RESIDENSSI 2 · RESIDENCE 2	45						

1. KERROS KONGRESSISIIPPI · 1ST FLOOR CONGRESS WING

BOARDROOM · BOARDROOM	52				12		
KOKOUSHUONE 10-11 · MEETING ROOM 10-11				6	6		
KOKOUSHUONE 12 · MEETING ROOM 12	36,6	30	16	12	24	16	
KOKOUSHUONE 15 · MEETING ROOM 15	82,7	30	30	16	30	30	
KOKOUSHUONE 16 · MEETING ROOM 16	53,5	20	16	12	12		

2. KERROS

2ND FLOOR

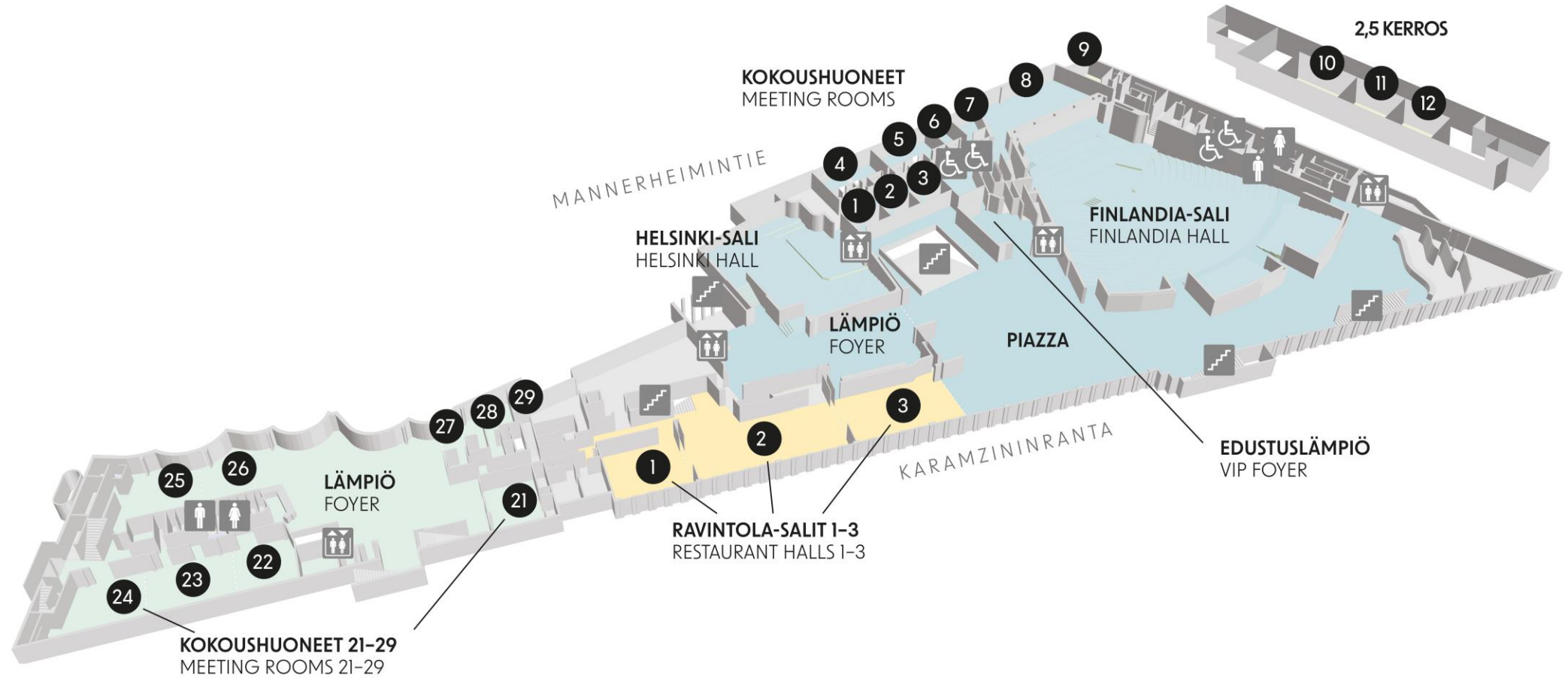



2. KERROS · 2ND FLOOR

	m ²	Tuolirivit Seating	Luokkamuto Classroom space	Kokouspöytä Meeting table	Pitkät pöydät Dinner tables	Pyöreät pöydät Round tables	Cocktail Cocktails
FINLANDIA-SALI · FINLANDIA HALL	Auditorio	1 672					
PIAZZA-LÄMPIÖ · PIAZZA FOYER	1 340				656	488	1 000
HELSINKI-SALI · HELSINKI HALL	Auditorio	340					
HELSINKI-SALIN LÄMPIÖ · HELSINKI HALL FOYER	310				188	144	250
KOKOUSHUONE 1 · MEETING ROOM 1	47	50	16	16			
KOKOUSHUONE 2 · MEETING ROOM 2	48	50	16	16			
KOKOUSHUONE 3 · MEETING ROOM 3	24	20	12	8-10			
KOKOUSHUONE 4 · MEETING ROOM 4	16	12		8			
KOKOUSHUONE 5 · MEETING ROOM 5	28	20	12	8-10			
KOKOUSHUONE 6 · MEETING ROOM 6	18			6			
KOKOUSHUONE 7 · MEETING ROOM 7	21			8			
KOKOUSHUONE 8 · MEETING ROOM 8	21	20	12	8-10			
KOKOUSHUONE 9 · MEETING ROOM 9	28	20	12	12			
KOKOUSHUONE 10 · MEETING ROOM 10	29	20	12	12			
KOKOUSHUONE 11 · MEETING ROOM 11	26	20	12	12			
KOKOUSHUONE 12 · MEETING ROOM 12	169	120	90	28	80	64/80	130

FINLANDIA-RAVINTOLA · FINLANDIA RESTAURANT · 430 m²

SALI 1 · HALL 1	92	92	34		70	40	70
SALI 2 · HALL 2	193	200	90		170	120	190
SALI 3 · HALL 3	149	160	66		122	72	120
SALIT 1-3 · HALLS 1-3	430	480	220		340	272	400
SALIT+PIAZZA-LÄMPIÖ · HALLS+PIAZZA-FOYER					1 284	960	1 400

2. KERROS KONGRESSISIIPPI · 2ND FLOOR CONGRESS WING

LÄMPIÖ · FOYER	412				144	136	300
KOKOUSHUONE 21 · MEETING ROOM 21	52	54	18	12	32	24	25
KOKOUSHUONE 22 · MEETING ROOM 22	60	33	20	16	32	24	30
KOKOUSHUONE 23 · MEETING ROOM 23	83	60	30	20	48	32	60
KOKOUSHUONE 22+23 · MEETING ROOM 22+23	144	93	50	30	80	64	90
KOKOUSHUONE 24 · MEETING ROOM 24	77	40	24	16	36	24	50
KOKOUSHUONEET 22+23+24 · MEETING ROOM 22+23+24	221	174	96		128	96	140
KOKOUSHUONE 25 · MEETING ROOM 25	98	40	32	18	36	32	50
KOKOUSHUONE 26 · MEETING ROOM 26	56	30	22	16	24	16	30
KOKOUSHUONEET 25+26 · MEETING ROOM 25+26	154	126	64	30	108	64	80
KOKOUSHUONE 27 · MEETING ROOM 27	14	9		4-6	4		
KOKOUSHUONE 28 · MEETING ROOM 28	13	9		4-6	4		
KOKOUSHUONE 27-28 · MEETING ROOM 27-28	27	20			8		
KOKOUSHUONE 29 · MEETING ROOM 29	21	20	12	8	8		

3. KERROS

3RD FLOOR

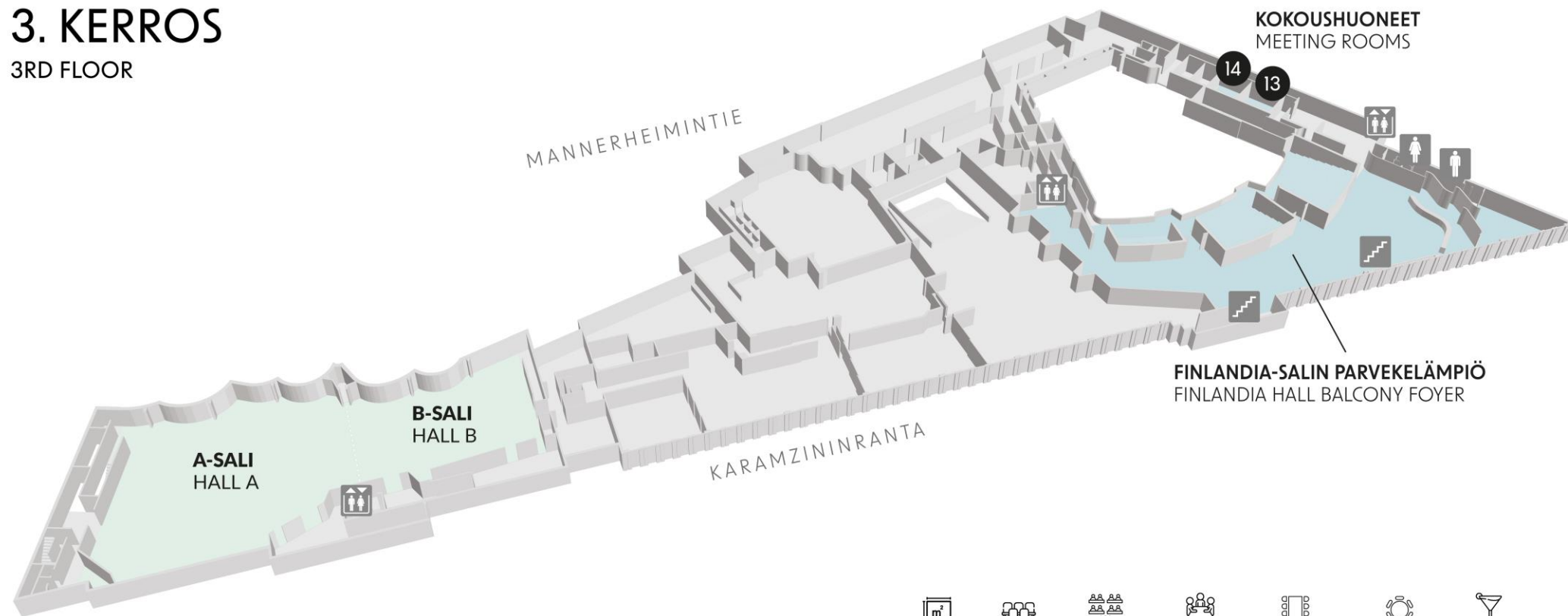

3. KERROS · 3RD FLOOR

FINLANDIA-SALIN PARVEKELÄMPIÖ ·
FINLANDIA HALL BALCONY FOYER

KOKOUSHUONE 13 · MEETING ROOM 13 · SKEPPET

KOKOUSHUONE 14 · MEETING ROOM 14 · LAPPIA

m ²	Tuolirivit Seating	Luokamuoto Classroom space	Kokouspöytä Meeting table	Pitkät pöydät Dinner tables	Pyöreät pöydät Round tables	Cocktail Cocktails
----------------	-----------------------	-------------------------------	------------------------------	--------------------------------	--------------------------------	-----------------------

684

26

15

12

12

28

20

12

3. KERROS KONGRESSISIIPPI · 3RD FLOOR CONGRESS WING

KONGRESSISALI A · CONGRESS HALL A

KONGRESSISALI B · CONGRESS HALL B

SALIT A+B · HALLS A+B

635

600

320

312

296

575

345

250

132

180

136

290

980

900

450

576

440



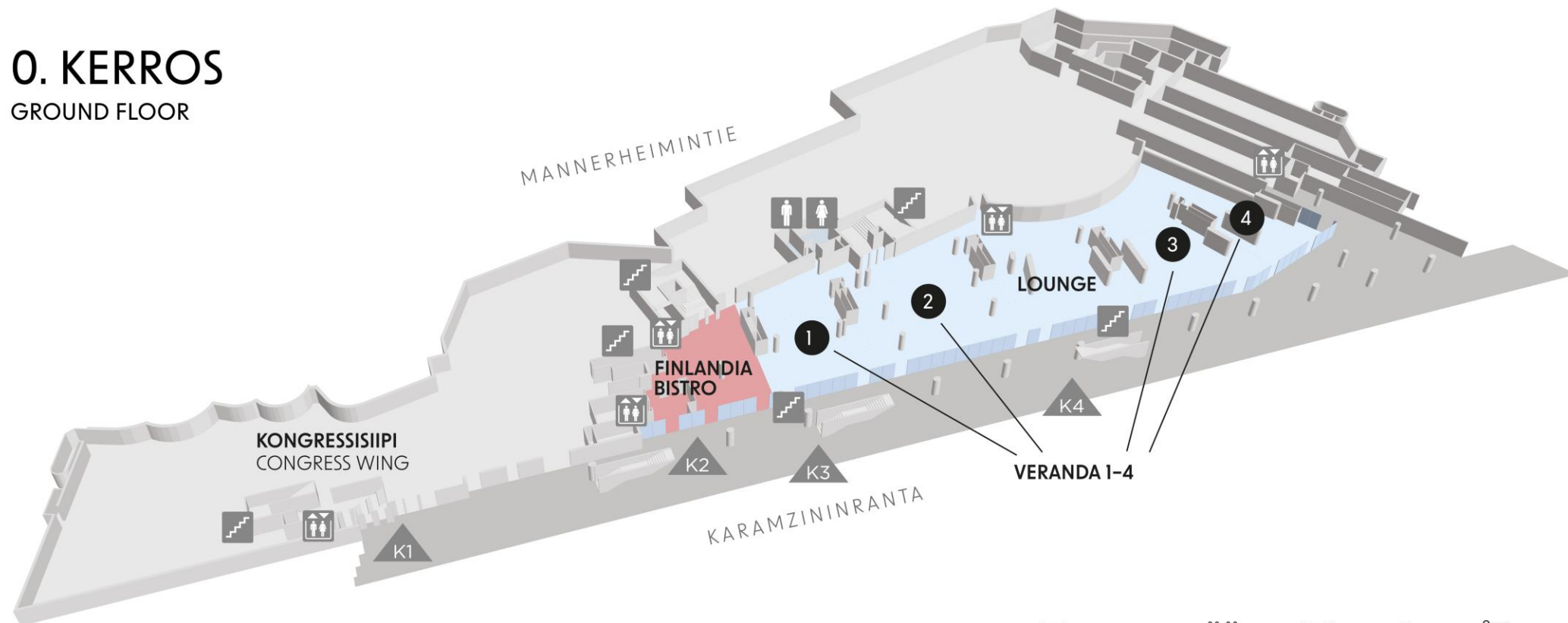

870

0. KERROS

GROUND FLOOR

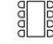

0. KERROS · GROUND FLOOR

	 m ²	 Tuolirivit Seating	 Luokamuoto Classroom space	 Pitkät pöydät Dinner tables	 Pyöreät pöydät Round tables	 Cocktail Cocktails
FINLANDIA BISTRO	215					
LOUNGE · VERANDA · 2 200 m²						
VERANDA 1 · VERANDA 1	233	200	108	104	120	230
VERANDA 2 · VERANDA 2	414	420	220	260	220	410
VERANDA 1+2 · VERANDA 1+2	647	620	328	364	360	640
VERANDA 3 · VERANDA 3	236	195	98	144	120	230
VERANDA 4 · VERANDA 4	272	220	140	172	160	270
VERANDA 3+4 · VERANDA 3+4	509	415	238	316	280	500
VERANDA 1-4 · VERANDA 1-4	1 156	1 035	566	680	700	1 100
VERANDAT+AULA, LÄMPIÖ VERANDA+FOYER	2 200			1 070	800	1 500

**EXCLUSIVE NEW
SERVICES AND FACILITIES
ELEVATE YOUR EVENT
TO THE NEW LEVEL**

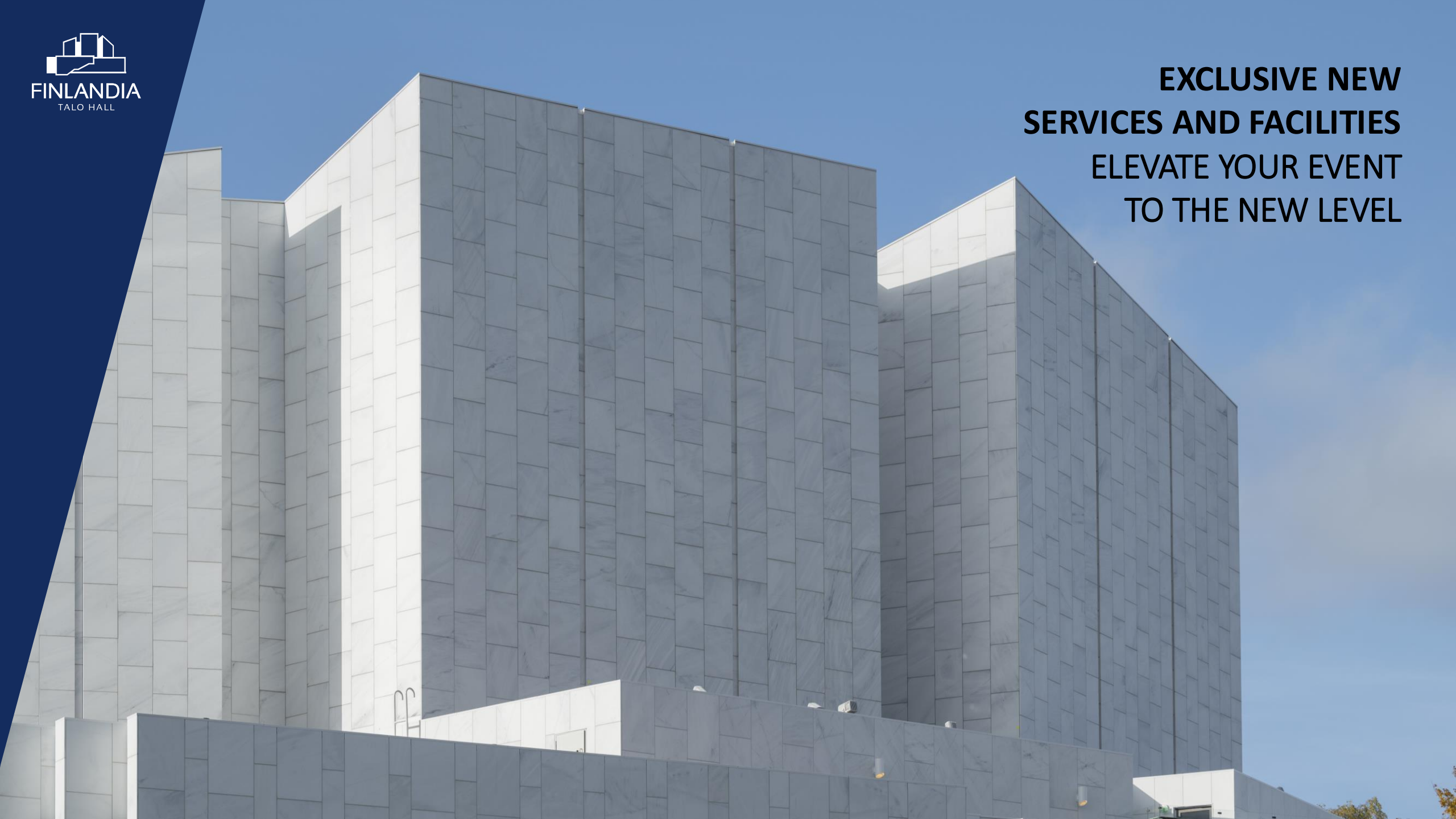



— VIDEO MATERIAL

[Finlandia-talo / Finlandia Hall 2025](#)

[Aerial footage of Finlandia Hall](#)

[Finlandia Hall virtual site visit](#)

[Finlandia Hall 360 Visualizer](#)

[The Story of Finlandia Hall](#)

CONTACT

Johanna Vappula

Senior Sales Manager International Sales

johanna.vappula@finlandiatalo.fi

+358 50 3642304

FINLANDIA HALL

Mannerheimintie 13 e , 00100 Helsinki

www.finlandiatalo.fi

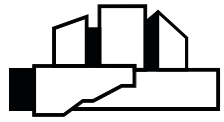

FINLANDIA
TALO HALL

**THANK
YOU**